

## Tagging Guide

Use the pusher rod to drive a tag into the applicator jaws.

- Dip the applicator jaws into disinfectant.  
*Do not immerse the entire drum!*

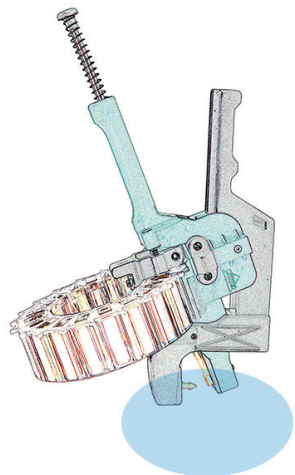

### Tagging lambs

- Hold the lamb securely.
- Position the tag on the upper edge of the ear, close to the head, about a third of the way from the base of the ear).
- The spike of the tag should go in from the top of the ear. The tag number should be on the top of the ear, and the microchip should be on the inside of the ear.
- Avoid piercing the cartilage 'ribs' of the ear, which can deform the ear or result in infection.
- Leave room for the ear to grow. Allow 1/4 inch of space between the loop of the tag and the edge of the ear.
- Squeeze the handles together until you hear the click as the tag snaps closed.
- Push the rod firmly all the way in to load the next tag into the jaws.

### Tagging older sheep

- Hold the animal securely.
- Position the tag on the upper edge of the ear, close to the head if possible.
- If the ears are very thick then tag a bit further out where the skin is thinner, or on the bottom of the ear.
- The spike of the tag should go in from the top of the ear. The tag number should be on the top of the ear, and the microchip should be on the inside of the ear.
- Avoid piercing the cartilage 'ribs' of the ear, which can deform the ear or result in infection.
- Squeeze the handles together until you hear the click as the tag snaps closed.
- Push the rod firmly all the way in to load the next tag into the jaws.

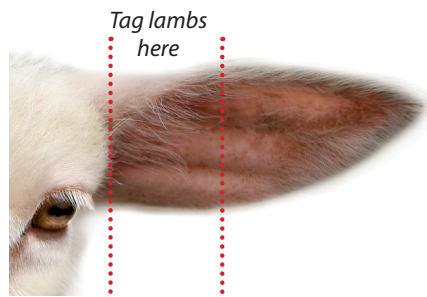

Drum cartridges  
- front



## Loading a drum cartridge

- Drum cartridges hold 20 tags.
- Cartridges are loaded in order of tag numbers.
- The first tag in the sequence is marked by an arrow etched into the plastic of the cartridge.
- For single tagging- load the drum and start tagging - the order of tags doesn't matter.
- For double / paired tagging - you must load the drum to start tagging at the first tag.

### Pull back the catch with your thumb

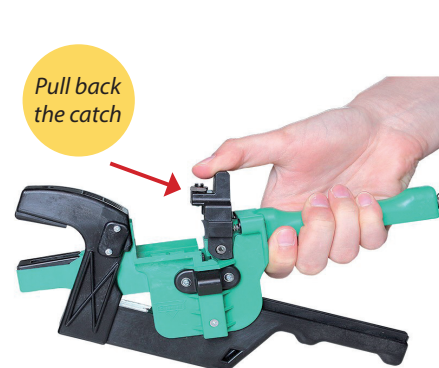

### Insert the cartridge - release the catch



### For double tagging pull back the catch and rotate the cartridge to the correct starting position

- The start arrow should be centred at the bottom, pointing forward.
- Release the catch to lock the cartridge in place.

Start with the tag marked by the arrow

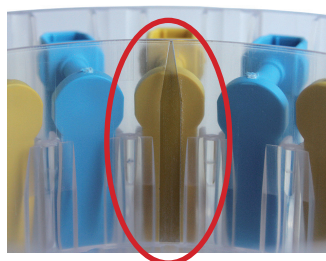

## Push the rod all the way in

- Apply enough force to push the tag out of the cartridge and into the jaws.
- The rod must go as far in as possible.
- Listen for an audible click when the tag is firmly in the jaws.
- Release the rod. You are ready to tag a sheep.

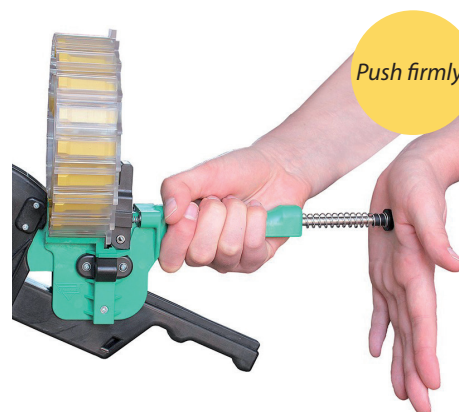

## Squeeze the handles together to close the tag

- The cartridge turns automatically every time the handles are closed so the next tag is in position.
- Push the rod after each tag is applied to move the next tag into the jaws.

Ready to tag!

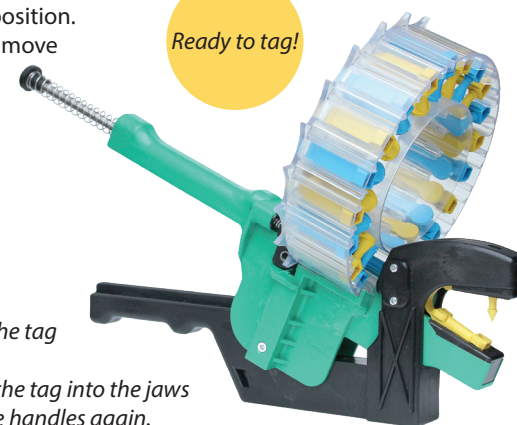

## Trouble-shooting

### - The applicator won't close

You haven't pushed the rod all the way, so the tag isn't far enough forward in the jaws. Push the rod in with enough force to move the tag into the jaws until you hear a click, then try squeezing the handles again.

### - The pusher rod won't go in

The cartridge is not seated properly - it is in between tags. Adjust the cartridge and try again.

### - Tag doesn't release easily from the applicator after tagging

Tip the front of the applicator downward immediately after applying the tag - this will pop the tag out of the jaws.